

PRICE REDUCTION

~~\$7,600,000~~
\$6,900,000



Your Neighborhood Theme Park

FOR SALE

Unique BIG BOX
at Iconic I-10 & Ray Road Intersection

845 NORTH 54TH STREET
Chandler | Arizona

ORION 
INVESTMENT REAL ESTATE



ORION Investment Real Estate, as exclusive advisor, is pleased to present the opportunity to acquire, free and clear, a **33,496 square foot retail asset in popular Chandler, Arizona**. The property is located at one of the most prestigious commercial intersections in Maricopa County - **Interstate 10 and Ray Road**. This affluent trade area is completely built out among residential developments and is one of the most popular upscale shopping destinations in the entire metropolitan Phoenix.

Ahwatukee Foothills Towne Center and Foothills Park Place, (Target, AMC, Marshall's Sprouts, Hobby Lobby, Mountainside Fitness, JC Penney, et al), are located on the west side of I-10 in the city of **Phoenix**. Chandler Pavilions and Shoppes at Casa Paloma (Lowe's, Home Depot, Sam's Club, AJs Fine Market, In N Out, et al), are in **Chandler** on the east side of the freeway. **Together, these retail properties offer over 1,000,000 square feet of quality retailers in one trade area.**

The subject building is a big box anchor store located in Chandler Pavilions regional shopping center, adjacent to the very high-end Shoppes at Casa Paloma. It has great visibility from N. 54th Street and Harrison Street and is right across the street from the Arizona Coyote Hockey Team's Chandler Ice Den location, a world-class 80,000 square foot indoor ice rink facility that draws patrons from all of Maricopa County. Freeway digital signage is available to the future owner/user.

The building is currently vacant. It originally opened as an Ultimate Electronics that closed several years ago. In 2017, the building was bought by a user to develop a family entertainment center and was renovated substantially with everything from new HVAC to a commercial kitchen. A list of improvements is included in this package.

The building has an imposing façade, massive parking lot, two truck wells, and four roll up doors located in the back. **In addition to retail, it could also accommodate office or medical users within the PAD zoning.** Industrial flex buildings are located immediately to the south and are well leased. The 34 acres across Harrison Street are zoned I-1 and are designated for future employment, specifically advanced manufacturing uses such as semi-conductors.

The Offering:	
Offering Price:	\$6,900,000
Price Per SF:	\$206

Site Description:	
Parcel Numbers:	301-84-888; 301-84-895
Zoning:	PAD
Floors:	1
Year Built/Renovated:	2000/2018
Rentable Square Feet:	33,496 SF
Lot Size:	2.83 Acres
Ownership:	Fee Simple
Clear Height:	21'9"
Beam Height:	18'9"
New Improvements:	HVAC, electrical, plumbing, structural, framing, flooring, painting, commercial kitchen set-up (no equipment), walk-in cooler, grease trap, sound system, restrooms, lighting fixtures, audio visual system, gas line, fire system
Signage:	Substantial signage on the building plus digital signage is available on project signs along I-10

Expenses:	
Property Tax:	\$62,860
Insurance:	\$8,000
CAM:	\$40,000

South Side of Subject Facing ICE DEN



- Vacant Retail Investment Opportunity Located in **Massive Power Retail Trade Area** that includes Local and National Users along equalling more than One Million Square Feet of Retail and more than 35 Restaurants
- Directly Adjacent of Iconic Retailers such as Home Depot, Sam’s Club, REI, World Market, Sportsman’s Warehouse and many more
- Major Freeway Access to Interstate 10 (I-10 - Phoenix to Tucson and Mexico - 150,000 VPD)
- 1 ½ Miles from Loop 202 to the south, and Four Miles from Loop 202 along the entire east side of Tempe, Scottsdale, and Phoenix
- Major Renovations have been made to Restrooms, Kitchen, Electrical, HVAC and much more

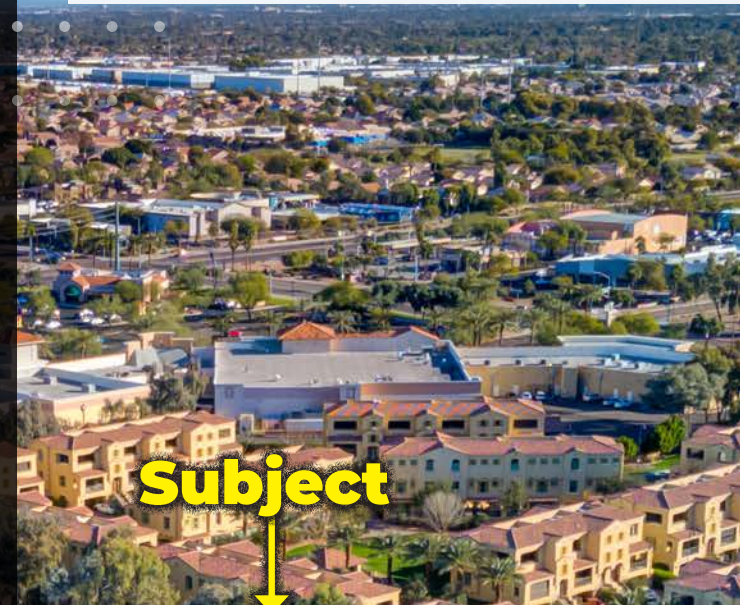

Subject

Trade Area has Exceptional Demographics in a 5-Mile Radius:

Total Employees:	123,448
Total Company Headquarters:	428
Average Household Size:	3.1 People
2022 Estimated Population:	204,812
2027 Estimated Population:	213,429
2022 Estimated Average Household Income:	\$107,366
2027 Estimated Average Household Income:	\$120,039
46.5% have a Bachelor’s degree or higher	



Future Advanced Manufacturing and Semiconductor Business Park
34 Acres

Subject

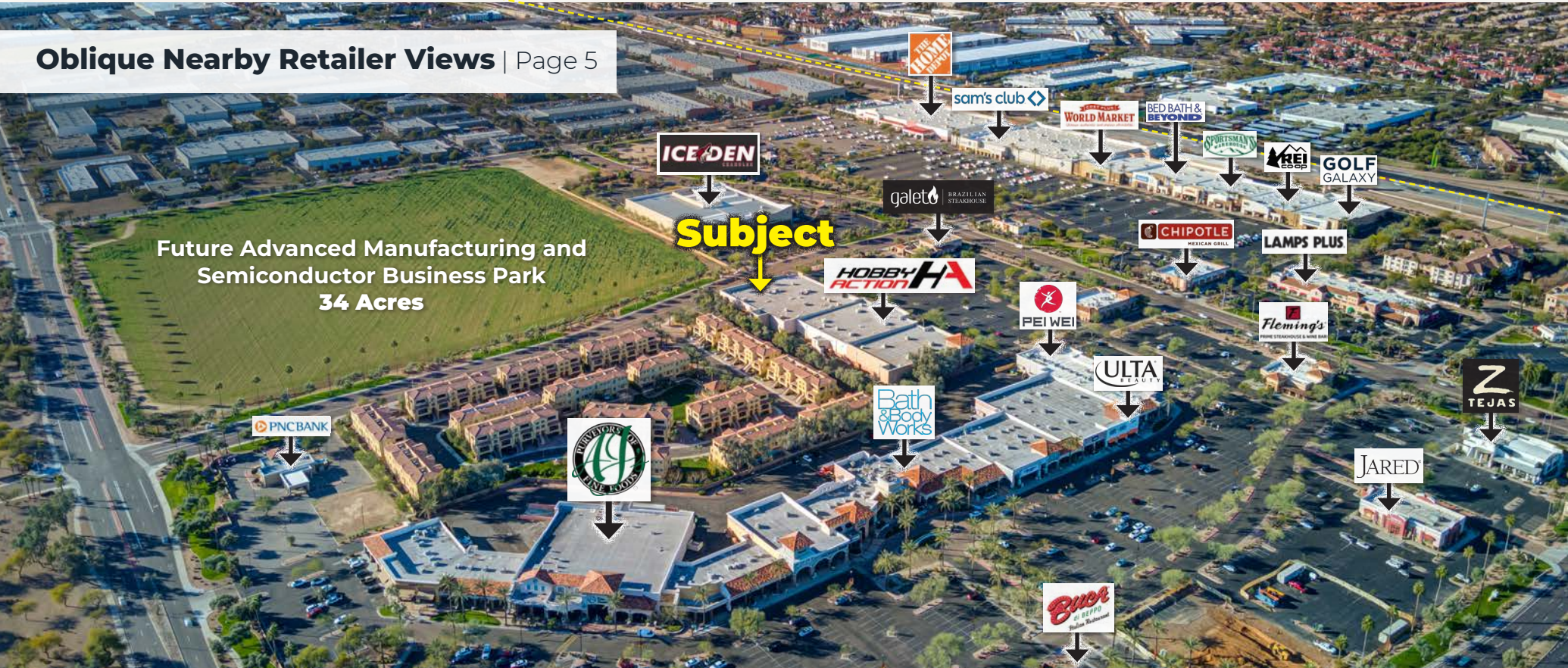

Future Advanced Manufacturing and Semiconductor Business Park
34 Acres





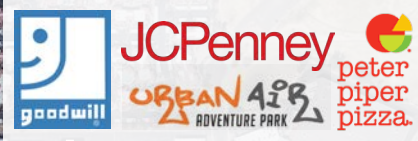

RAY ROAD: 42,939 VPD



Interstate 10: 182,446 VPD



Harrison Street

Future Advanced Manufacturing and Semiconductor Business Park

Galveston Street

CONVERGE LOGISTICS CENTER Under Construction



48th Street

54th Street

56th Street

Priest Drive

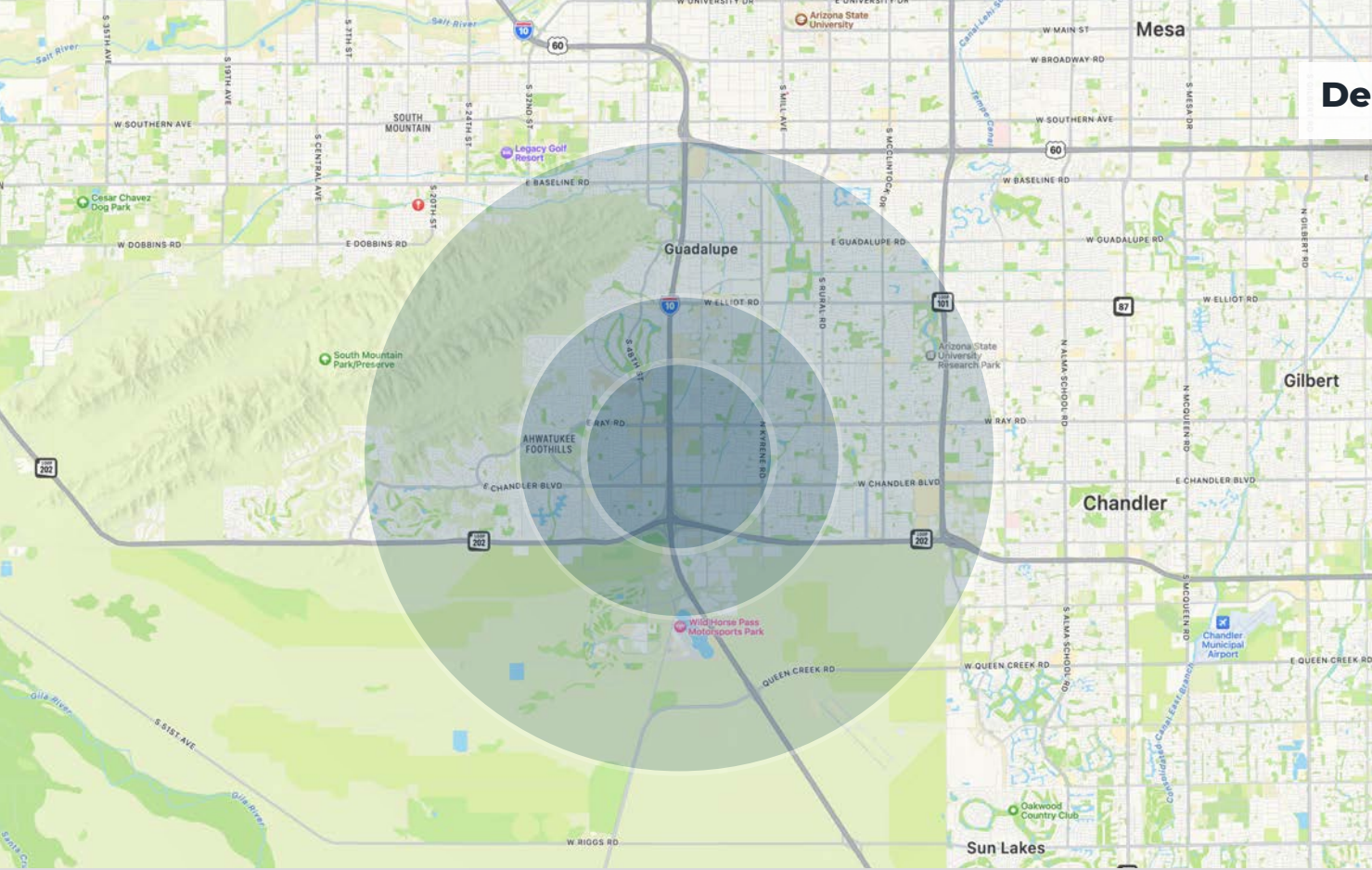

Daytime
Population:
328,260

* 5 mile radius



Median Age:
37.5

* 5 mile radius

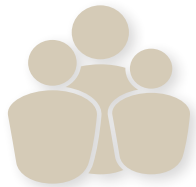

Average Household
Income:
\$120,039

* 1 mile radius

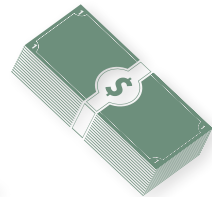

2022 Summary (SitesUSA)	Two Mile	Three Mile	Five Mile
Daytime Population:	87,828	163,206	328,260
Residential Population:	46,069	98,704	204,812
Average Household Income:	\$95,888	\$110,013	\$107,366
Projected Household Income:	\$102,714	\$119,730	\$120,039
Average Household Size:	3.1	3.1	3.1
Average Family Income:	\$117,017	\$130,394	\$128,790
Total Employees:	41,759	64,502	123,448
Total Businesses:	3,139	5,701	10,995
Company Headquarter Businesses:	154	243	428
Median Age:	37.5	38.1	37.6

Chandler's proactive leadership, corporate-friendly environment, world-class labor force and market reach have made it an attractive location for businesses of all sizes and industries. The community is committed to developing a sense of place that draws new visitors and enriches the lives of residents.

Chandler is regarded as one of the most financially stable cities in the United States, evidenced by its AAA bond rating from each major bond rating agency.

This fiscal health stems from City leadership's understanding of the importance of a strong local economy.

The City has worked for decades to build a location for business success and to create a sense of place that is appealing to large and small businesses alike.

The following are some of the advantages of doing business in Chandler:

- Pro-business local government that is responsive to the needs of the business community
- City staff capable of assisting businesses of all sizes, from startups to multinational corporations
- Programs and services to support businesses locating and expanding in Chandler
- Sound, long-term fiscal policies to ensure Chandler is a safe place for private sector investment
- Lowest city sales tax rate among the metro area's major cities at 1.5 percent
- Minimalist state regulatory environment and among the lowest corporate income tax rates at 4.9 percent

Nationwide Community Rankings (2020-2022)

- • • • • **5th Best City for Women in Tech** (SmartAsset 2022)
- • • • • **16th Best Place to Find a Job** (WalletHub 2022)
- • • • • **7th Best Cities to Buy a Family Home** (SmartAsset 2021)
- • • • • **2nd Most Prosperous Large Cities** (Economic Innovation Group 2020)
- • • • • **6th Most Livable City in the U.S.** (SmartAsset 2020)
- • • • • **8th Best Untapped Cities for Startups** (Fundera 2020)
- • • • • **15th Best City for Women Entrepreneurs** (Fundera 2020)

Chandler is the fourth largest City in Arizona and is one of the fastest growing innovation and technology centers in the nation.

Chandler's supportive business climate attracts global industry leaders, startups, and skilled workers.

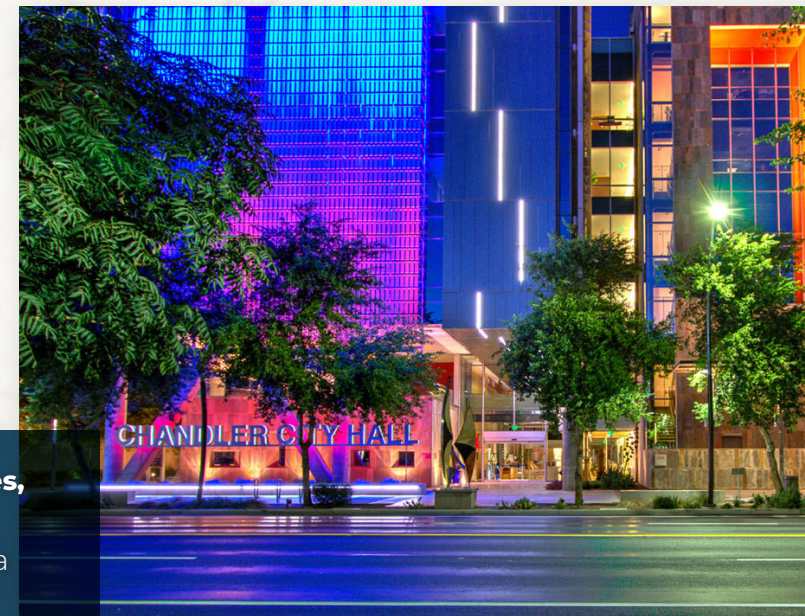

Arizona is the 6th-largest state and the 14th-most-populous of the United States. Its capital and largest city is Phoenix. Arizona is the 48th state and last of the contiguous states to be admitted to the Union, achieving statehood on February 14th, 1912. Arizona's population and economy have grown exponentially since the 1950s because of inward migration. The state is home to major universities including Arizona State University and the University of Arizona.

Arizona is home to a surging ecosystem of global giants, early stage entrepreneurs and tech-savvy Millennial talent who are breaking new ground across a wide range of industry growth sectors. Arizona offers a robust portfolio of programs and resources supporting both large and emerging tech employers.



ARIZONA PUTS BUSINESS FIRST

#1

in the nation for
Entrepreneurial
Activity

4.9%

corporate income tax
among the
lowest in the nation

300

sunny days
per year

#2

in the nation in
unemployment
insurance tax

Phoenix is the 11th largest Metropolitan area by population in the United States with 4,857,962 residents. In addition, Phoenix is the county seat of Maricopa County, and is the sixth largest city in the United States by land area.

The largest capital city in the United States, Phoenix is the only state capital with over 1,000,000 people. The evolution of Downtown Phoenix over the last 5 years has been significant with more than \$4 Billion invested in office space, retail, restaurants, educational facilities, convention space, and hotels.

All materials and information received or derived from ORION Investment Real Estate its directors, officers, agents, advisors, affiliates and/or any third-party sources are provided without representation or warranty as to completeness, veracity, or accuracy, condition of the property, compliance, or lack of compliance with applicable governmental requirements, developability or suitability, financial performance of the property, projected financial performance of the property for any party's intended use or all other matters.

Materials and information from any source, whether written or verbal, that may be furnished for review are not a substitute for a party's active conduct of its own due diligence to determine these and other matters of significance to such party. ORION Investment Real Estate will not investigate or verify any such matters or conduct due diligence for a party unless otherwise agreed in writing.

EACH PARTY SHALL CONDUCT ITS OWN INDEPENDENT INVESTIGATION AND DUE DILIGENCE.

Any party contemplating or under contract or in escrow for a transaction is urged to verify all information and to conduct their own inspections and investigations including through appropriate third-party independent professionals selected by such party. All financial data should be verified by the party including by obtaining and reading applicable documents and reports and consulting appropriate independent professionals. ORION Investment Real Estate makes no warranties and/or representations regarding the veracity, completeness, or relevance of any financial data or assumptions. ORION Investment Real Estate does not serve as a financial advisor to any party regarding any proposed transaction. All data and assumptions regarding financial performance, including that used for financial modeling purposes, may differ from actual data or performance. Any estimates of market rents and/or projected rents that may be provided to a party do not necessarily mean that rents can be established at or increased to that level. Parties must evaluate any applicable contractual and governmental limitations as well as market conditions, vacancy factors and other issues to determine rents from or for the property.

Legal questions should be discussed by the party with an attorney. Tax questions should be discussed by the party with a certified public accountant or tax attorney. Title questions should be discussed by the party with a title officer or attorney. Questions regarding the condition of the property and whether the property complies with applicable governmental requirements should be discussed by the party with appropriate engineers, architects, contractors, other consultants, and governmental agencies. All properties and services are marketed by ORION Investment Real Estate in compliance with all applicable fair housing and equal opportunity laws.

Exclusively Listed by:



Judi Butterworth

Direct Phone: (480) 750-1215
Mobile Phone: (602) 315-2541
judi.butterworth@orionprop.com



Michael Douglas

Direct Phone: (480) 977-2935
Mobile Phone: (480) 772-8870
michael.douglas@orionprop.com

